

The designed building is the International Trading Center, which is six-story steel office building and located in Ho Chi Minh city, Vietnam. The dimension of the office building is 200 ft x 120 ft.

**Designed Load:**

Distributed Live Load:	Offices	50 psf
	Lobbies	100 psf
	Corridors, above the 1 <sup>st</sup> floor	80 psf
Concentrated Live load:	Office floor	2000 lb

There is no snow load and only little win load in Ho Chi Minh city!

**Designed Member:**

Interior Column: W 12 x 40  
Exterior Column: W 10 x 12  
Beams: W 8 x 15  
Concrete Slab: 0.75 ft

*Figure 1:* The 6-story steel International Trading Center in Ho Chi Minh city

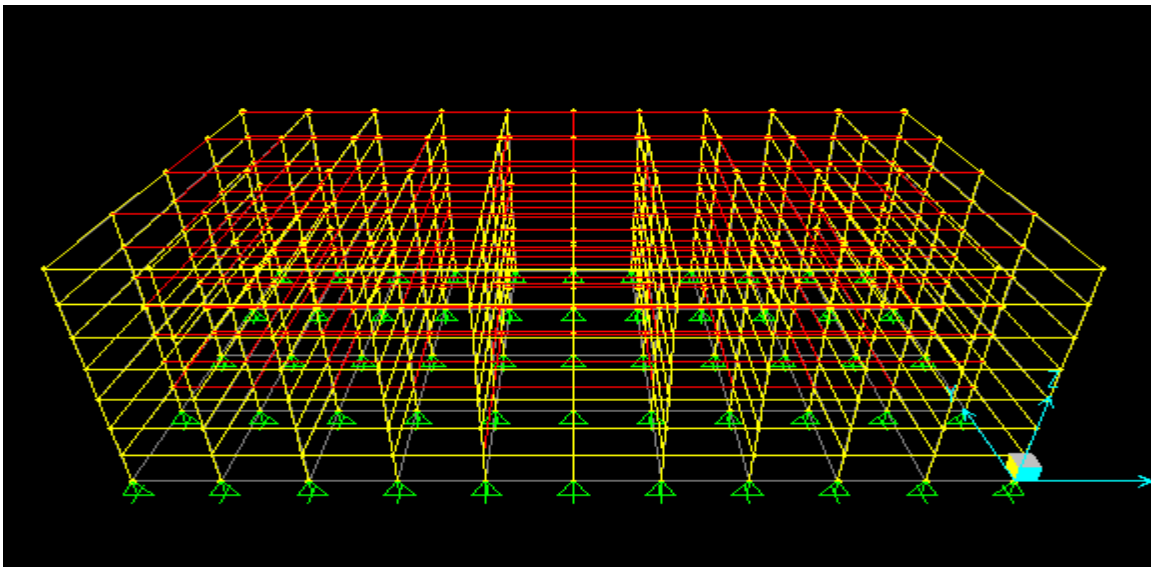

Figure 2: The deformed shape of the office building

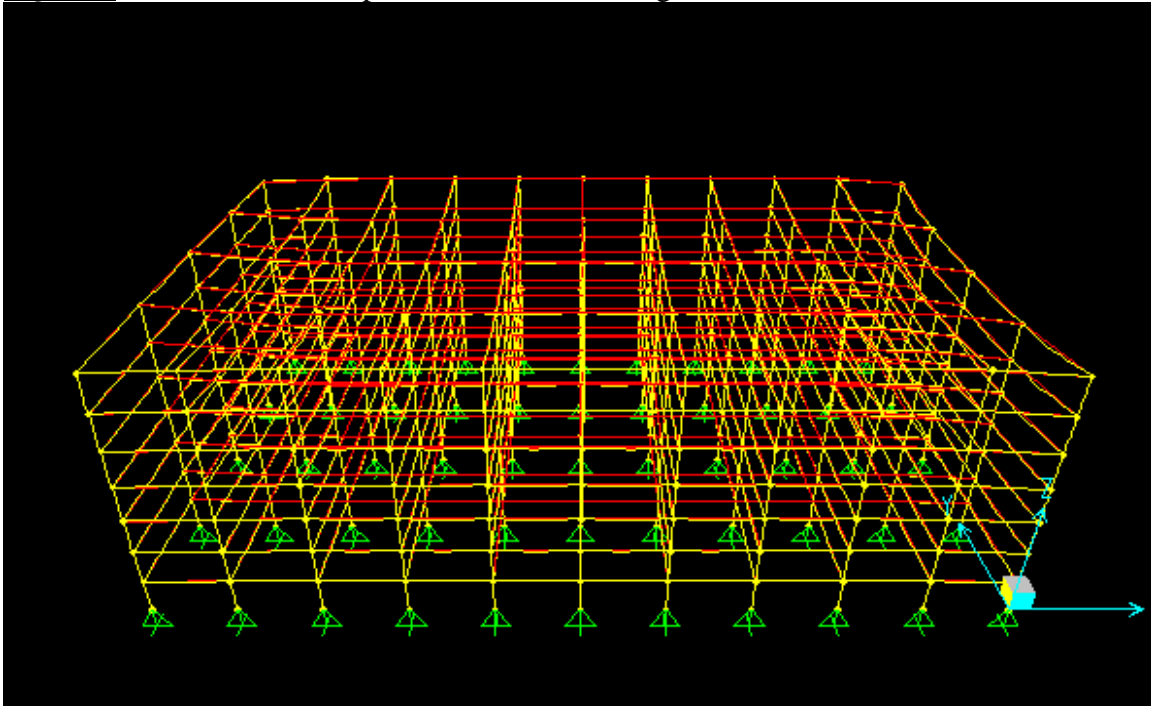
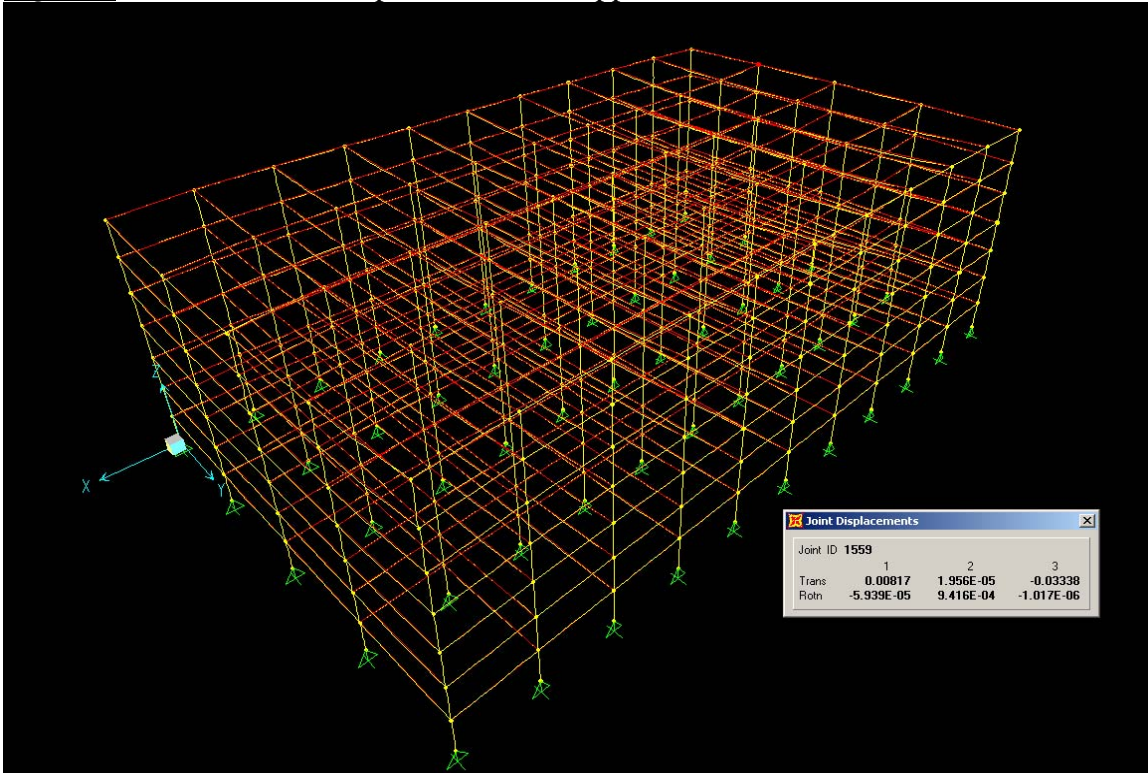

Figure 3: The Maximum Displacement after applied Loads



Allowed deflection is bigger than the maximum deflection; thus, the designed structure would be safe!